

8678800001

High Current PDU Fuses or Breakers

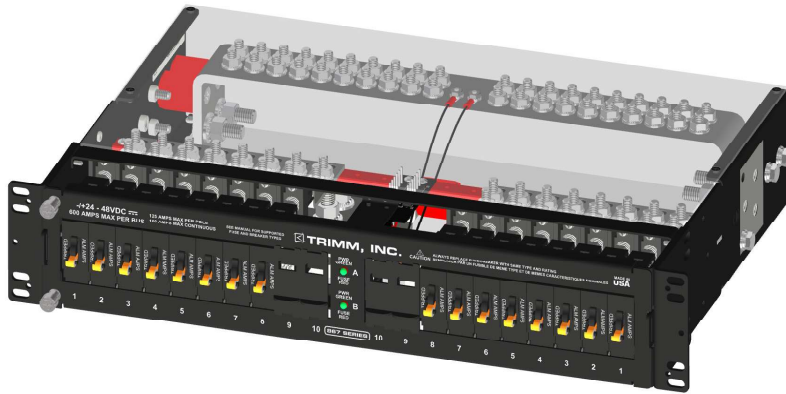

Positions Per Bus
8 Versa-Slots

Max Per Position
125 Amps

Bus Capacity
600 Amps

GENERAL	
Dimensions	19.00" W x 3.50" H x 14.500" D
Rack Space	2U (Includes a clear plastic top and bottom cover)
Weight	20.0 lbs.
Mounting	Universal 19" or 23", WECCO or EIA
Mtg. Pos.	Flush, 4" or 5" Offset
Finish	Black Textured Powder Coat w/zinc mtg
ELECTRICAL	
Input	Nominal Voltage -/+24-48V DC
	Voltage Range -/+19-60V DC
	Number of Buses 2
	Intr. Device Rating 750 Amps
Output	Max Rating by Type *TPS Fuse - 70 Amp *TLS Fuse - 125 Amp *Must purchase Fuse Holder Single Pole Breaker - 100A
	Continous Load Rating TLS Fuse - 100 Amp TPC Fuse - 100 Amp TPS Fuse - 56 Amp Single Pole Breaker - 80A
ALARMING	
Indicators	Bi-color LED Green (Power) Red (Alarm)
Function	Form C relay contacts for remote fuse and power fail indication
Conn. Type	Solderless Wire Wrap (18 to 30 AWG)
Rating	DC 30W/AC 50VA

Input	2 Hole Lug	Bat - 3/8" stud x 1" spacing, Rtn - 3/8" stud x 1" spacing or 1/4" stud x 5/8" spacing
	Wire Range	Up to 750 kcmil (x2)
	Max. Terminal Width	2.000"
	Tightening Torque	150 in-lb (16.9 Nm)
Output	2 Hole Lug	Bat - 1/4" stud x 5/8" spacing Rtn - 1/4" stud x 5/8" spacing or 3/8" stud x 1" spacing
	Wire Range	Up to 2/0 AWG
	Max. Terminal Width	0.625"
	Tightening Torque	24 in-lb (2.7 Nm)
Ground Bus	2 Hole Lug	1/4" stud x 5/8" spacing
	Wire Range	Up to 4/0 AWG
Short Term Op Temp	-5° C to +55° C	
Ambient	Up to 50° C	
Store Temp	-40° C to +70° C	
Humidity	0 to 95% non-condensing	
Dissipation	131 Watts max	
Safety (Recognized)	UL 60950-1/UL 1801/CSA C22.2 No.60950-1/EN 60950-1/IEC 60950-1	
Telcordia	NEBS Level 3 (GR-63/GR-1089) and GR-3108 Class 3 (w/o salt fog testing)	

High Current Power Distribution Unit, 8/8 Versa-Slots

8678800001

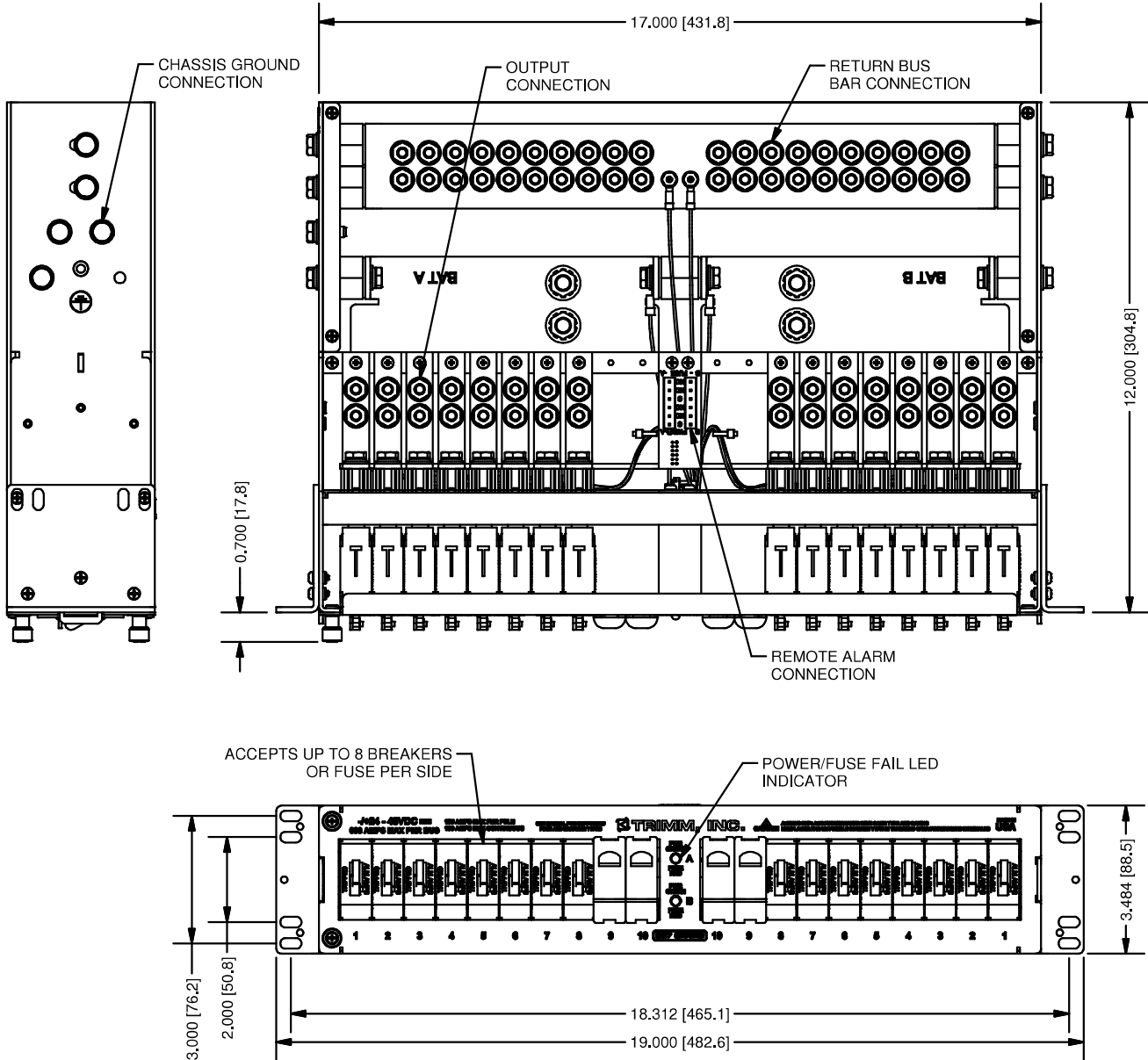

NOTES

Go to www.trimminc.com to order the fuses or circuit breakers for this panel. If you order TLS or TPS fuses with this panel, you will also need to order a fused disconnect for each fuse.